

# DiTemp® // -40...199.9 °C

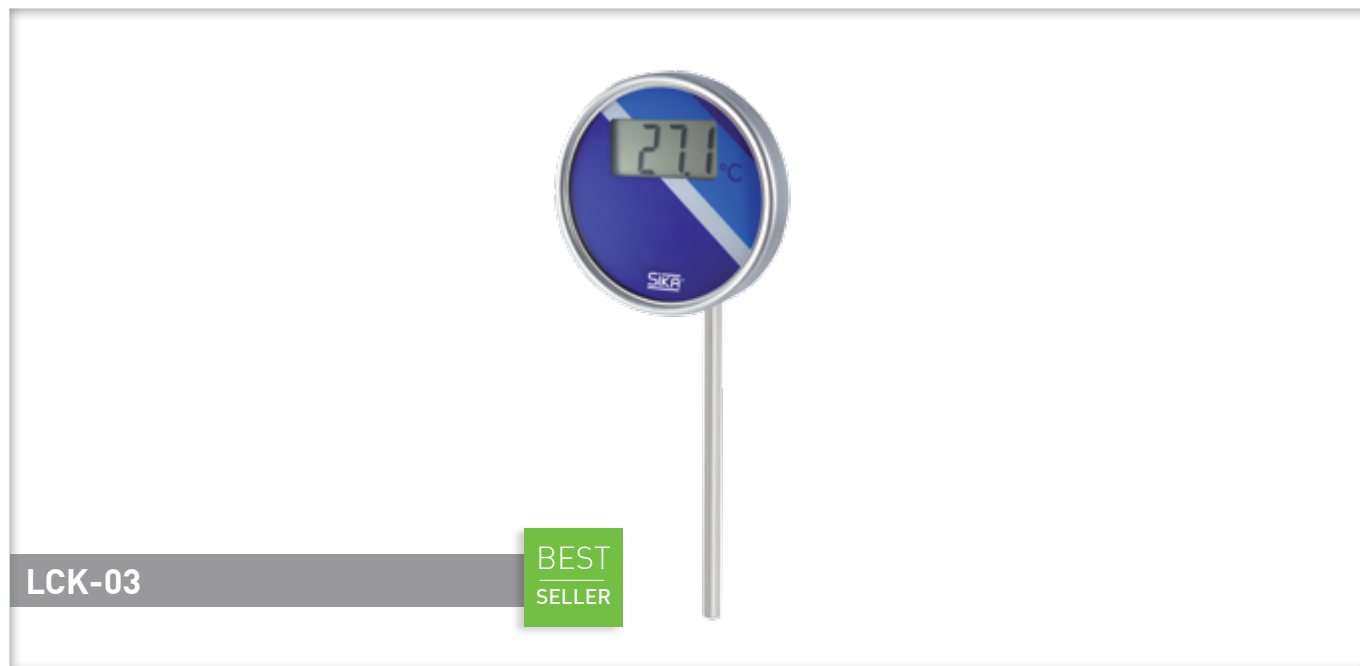

## Your advantages

Series	LCK-02 / LCK-03 / LCK-07
	<ul style="list-style-type: none"> <li>• Good readability of the process parameters → High contrast LCD display</li> <li>• Robust mechanical construction → Reliable and long-lasting operation</li> <li>• Continuous self-test → Maximum degree of operational safety</li> <li>• Up to 4 years of energy self-sufficient operation → Durable lithium battery</li> <li>• No complex cabling necessary</li> </ul>

## Technical data

Version	Straight
Dimensions	100 mm x 20 mm [D x D]
Measuring range	-40...199.9 °C
Medium / Application	Liquid and gaseous media
Immersion tube length	100...400 mm
Immersion tube diameter	8 mm
Process connection	Without, G $\frac{1}{4}$ , G $\frac{1}{2}$ , G $\frac{3}{4}$ , M20 x 1.5, M27 x 2
Pressure rating	PN 25
Display	3 $\frac{1}{2}$ digit, 7 segment display, 21 mm high
Resolution	0.1 K in the range -40...199.9 °C
Measuring rate	6 s
Medium temperature	See selected measuring range
Ambient temperature	5...60 °C
Storage temperature	5...60 °C

## Electrical data

Measuring element	Pt1000 / 2-wire / Class B
Accuracy	±1 % of range ±1 digit
Supply voltage	Button cell, 4 years service life

**LCK-02**

Immersion tube  
routed to the rear (axial)

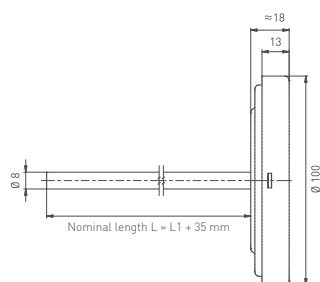

**LCK-03**

Immersion tube 90°

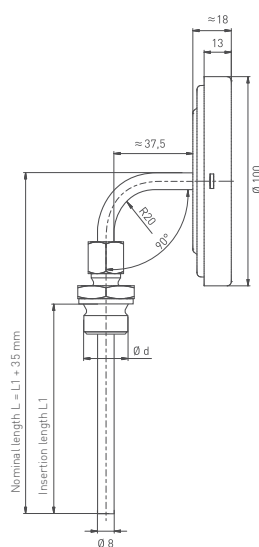

**LCK-07**

Immersion tube  
universally adjustable

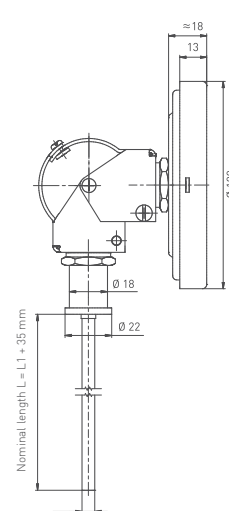

<b>Material</b>	
<b>Not in contact with medium</b>	
<b>Housing</b>	Stainless steel 1.4301 with polished front frame, glass or plastic front screen
<b>In contact with medium</b>	
<b>Process connection</b>	Stainless steel 1.4571
<b>Immersion tube</b>	Stainless steel 1.4571

Order code										
Type										
Immersion tube routed to the rear (axial)	LCK-02	9A2								
Immersion tube 90°	LCK-03	9A3								
Immersion tube universally adjustable	LCK-07	9A7								
Display range*										
-40...199,9 °C		42								
Immersion tube length* l <sub>1</sub>	Nominal length L = l <sub>1</sub> + 35 mm									
100 mm	135 mm	100								
160 mm	195 mm	160								
250 mm	285 mm	250								
400 mm	435 mm	400								
Connection type*										
Connection type A, plain immersion tube		1								
Connection type AK, adjustable compression fitting		9								
Thread type*										
None		0								
Connection type AKa, adjustable compression fitting (male thread)		2								
Connection type AKi, adjustable compression fitting (female thread)		3								
Connection thread*										
Without - plain immersion tube		0								
G¼		L								
G½		2								
G¾		3								
M20 x 1.5		7								
M27 x 2		9								
Immersion tube material*	Connection thread material*									
Stainless steel 1.4571	None		1							
Stainless steel 1.4571	Stainless steel 1.4571		3							
Immersion tube diameter										
8 mm		0								
Connecting cable*										
None		0								
Special features*										
None		0								
Shatter-proof plastic front screen (FDA version)		2								
Example order number		9A2	42	100	1	0	0	1	0	0

\* Other specifications are available on request

**BEST  
SELLER**

Type		Order number									
<b>LCK-02</b>	Immersion tube routed to the rear (axial), display range -40...199.9 °C l <sub>1</sub> = 100 mm, plain immersion tube tread type: none, stainless steel 1.4571, immersion tube diameter 8 mm, without connection cable	<b>9A2</b>	<b>42</b>	<b>100</b>	<b>1</b>	<b>0</b>	<b>0</b>	<b>1</b>	<b>0</b>	<b>0</b>	<b>0</b>
<b>LCK-02</b>	Immersion tube routed to the rear (axial), display range -40...199.9 °C l <sub>1</sub> = 160 mm, plain immersion tube tread type: none, stainless steel 1.4571, immersion tube diameter 8 mm, without connection cable	<b>9A2</b>	<b>42</b>	<b>160</b>	<b>1</b>	<b>0</b>	<b>0</b>	<b>1</b>	<b>0</b>	<b>0</b>	<b>0</b>